

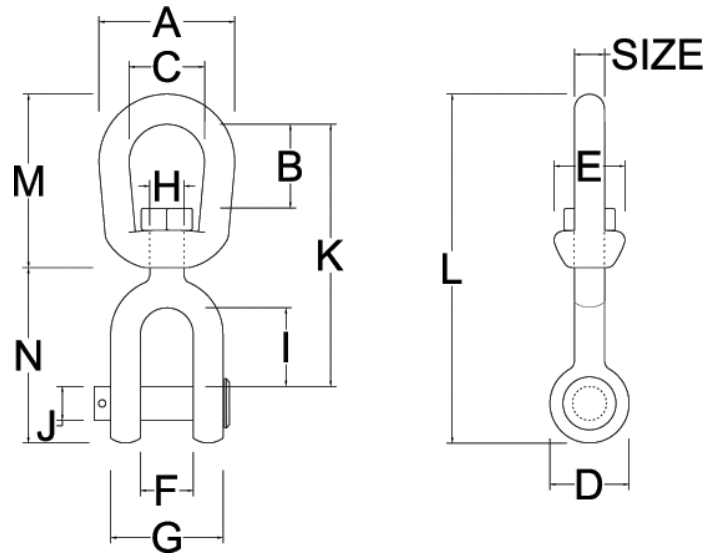

MARINE FENDERS INTERNATIONAL, INC.



JAW END SWIVELS

SIZE (IN.)	WORK LOAD LIMIT (LBS.)	WEIGHT EACH (LBS.)	DIMENSIONS INCHES													
			A	B	C	G	J	K	L	M	N	P	R	T	U	V
1/4	850	0.25	1.25	0.69	0.75	0.69	0.69	0.47	1.03	0.31	0.88	0.25	2.63	3.38	1.69	1.69
5/16	1250	0.37	1.63	0.81	1.00	0.81	0.81	0.50	1.13	0.38	0.88	0.31	2.94	3.88	2.06	1.81
3/8	2250	0.7	2.00	0.94	1.25	1.00	1.00	0.63	1.41	0.50	1.06	0.38	3.63	4.75	2.50	2.25
1/2	3600	1.43	2.50	1.31	1.50	1.31	1.31	0.75	1.75	0.63	1.31	0.50	4.50	6.06	3.19	2.88
5/8	5200	2.48	3.00	1.56	1.75	1.63	1.50	0.94	2.06	0.75	1.50	0.63	5.31	7.31	3.88	3.44
3/4	7200	3.88	3.50	1.75	2.00	1.88	1.88	1.13	2.53	0.88	1.75	0.75	6.06	8.31	4.31	4.00
7/8	10000	8.75	4.00	2.06	2.25	2.13	2.13	1.19	2.75	1.00	2.06	0.88	7.00	9.53	5.00	4.53
1	12500	10.25	4.50	2.31	2.50	2.63	2.38	1.75	3.72	1.13	2.81	1.13	8.56	11.69	5.75	5.94
1 1/4	18000	15.75	5.69	2.69	3.13	3.31	3.00	2.06	4.31	1.38	2.81	1.38	9.44	13.13	6.75	6.38
1 1/2	45200	54.75	7.00	4.19	4.00	5.63	4.00	2.88	6.00	2.25	4.44	2.25	14.75	20.84	10.00	10.84