

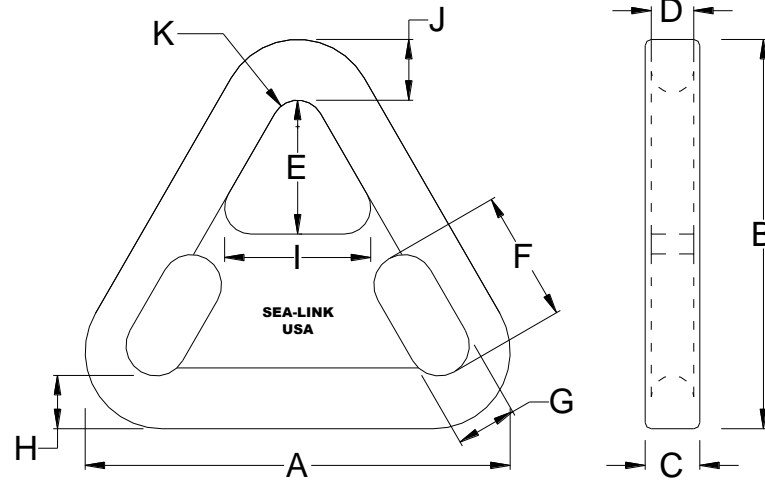

MARINE FENDERS INTERNATIONAL, INC.



TOWING PLATES

| Plate Number | Shackle Size | | A | | B | | C | | D | | E | | F | | G | | H | | I | | J | | K | | L | | M | | Weight | |
|--------------|--------------|----------|------|-----|------|-----|-----|-----|-----|-----|------|-----|------|-----|-----|-----|-----|-----|------|-----|-----|-----|-----|-----|------|-----|-----|-----|--------|-------|
| | in. | mm. | in. | mm. | in. | mm. | in. | mm. | in. | mm. | in. | mm. | in. | mm. | in. | mm. | in. | mm. | in. | mm. | in. | mm. | in. | mm. | in. | mm. | in. | mm. | lbs. | kilos |
| NO. 1 | 1.5 - 2.0 | 38 - 51 | 17.5 | 445 | 16.0 | 406 | 2.3 | 57 | 1.8 | 44 | 5.5 | 140 | 5.4 | 137 | 2.0 | 51 | 2.3 | 57 | 6.0 | 152 | 2.5 | 64 | 1.0 | 25 | 0.25 | 6 | 2.3 | 57 | 65 | 30 |
| NO. 2 | 2.25 - 3.0 | 57 - 76 | 22.5 | 572 | 23.0 | 584 | 3.0 | 76 | 2.0 | 51 | 7.0 | 178 | 7.0 | 178 | 3.0 | 76 | 3.3 | 83 | 7.0 | 178 | 4.0 | 102 | 1.5 | 38 | 0.38 | 10 | 3.0 | 76 | 165 | 75 |
| NO. 3 | 3.5 - 4.0 | 90 - 100 | 31.0 | 787 | 31.0 | 787 | 4.0 | 102 | 3.0 | 76 | 10.0 | 254 | 10.0 | 254 | 4.0 | 102 | 4.4 | 111 | 10.0 | 254 | 5.5 | 140 | 2.0 | 51 | 0.38 | 10 | 4.0 | 102 | 550 | 250 |

Dimensions and heights are subject to change. Dimensions are based on inches and pounds.

TOW PLATE SPECIFICATIONS

| Plate Number | Proof Load | |
|--------------|------------|---------|
| | lbs. | kg. |
| NO. 1 | 300,000 | 136,364 |
| NO. 2 | 485,000 | 220,455 |
| NO. 3 | 624,000 | 283,636 |

All towing plates are supplied with a certificate of conformance and pull test certificates from the factory.

Marine Fenders International, Inc.

• 909 Mahar Avenue • Wilmington • California • 90744 • USA

Telephone 1-310-834-7037 • Fax 1-310-834-7825 • E-mail: sales@marinefendersintl.com • www.marinefendersintl.com